

# LAW SCHOOL BUILDING AND OLD QUADRANGLE



LAW SCHOOL BUILDING  
AND OLD QUADRANGLE  
SOHE 2008



LAW SCHOOL BUILDING  
AND OLD QUADRANGLE  
SOHE 2008



LAW SCHOOL BUILDING  
AND OLD QUADRANGLE  
SOHE 2008



LAW SCHOOL BUILDING  
AND OLD QUADRANGLE  
SOHE 2008



1 law school building &  
old quadrangle university of  
melbourne parkville west  
facade

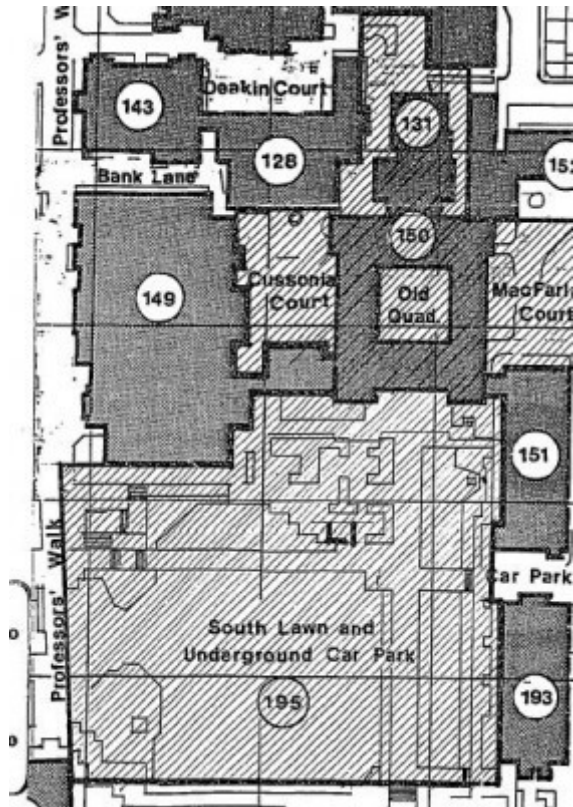

h00920 plan h0920

---

## Location

THE UNIVERSITY OF MELBOURNE, 156 - 292 GRATTAN STREET PARKVILLE, MELBOURNE CITY

## Municipality

MELBOURNE CITY

## Level of significance

Registered

## Victorian Heritage Register (VHR) Number

H0920

## Heritage Overlay Numbers

HO342

## VHR Registration

June 24, 1992

## Heritage Listing

## Statement of Significance

Last updated on - May 16, 2000

What is significant?

The University of Melbourne was established in 1853. The first buildings, now known as the Law School Building and Old Quadrangle, were constructed from 1854 -1857 to the competition winning designs of architect F M White. This original structure comprised the east and west wings of the quadrangle and the north cloister. The works completed in 1857 represented only a portion of White's original design. The north annexe was added in 1873-75, probably to designs by Reed and Barnes. Up to this time all construction was with Tasmanian freestone sourced from near Hobart. The initial east and west wings housed lecture rooms and accommodation for the first professors and their families. The north wing housed a library, museum and further lecture rooms. The cloisters and southern extensions to the east and west wings were added in 1930 to designs by the University's architects Gawler and Drummond. The later construction was of reconstituted stone with a coarse aggregate concrete and faced with a coloured cement. The Law Faculty gradually took over most of the Quadrangle as other faculties were constructed on the campus. The south wing was built in 1970 to designs by University Staff Architect Rae Featherstone. This work finally enclosed the Quadrangle as originally intended.

The complex follows the Oxford and Cambridge University models of a quadrangle plan, cloisters and Gothic revival styling. The Gothic revival style chosen by F M White includes steeply pitched slate clad roofs, castellated parapets, Tudor arched openings, buttresses, square headed windows with cusping, and stone flagged pavements. The upper Law theatre retains its hammer beam roof trusses.

How is it significant?

The Law School Building and Old Quadrangle is of historic, architectural and social significance to the State of Victoria.

Why is it significant?

The Law School Building and Old Quadrangle is historically significant for providing the first permanent accommodation for the University of Melbourne. As such, they provide a tangible link with the founding of the University. The buildings represented the centre of university life until well into the twentieth century.

The Law School Building and Old Quadrangle is architecturally significant as a stylistic demonstration of the University's close links with British universities in the mid-nineteenth century. The use of the Gothic revival style was a clear demonstration of this association and was expressed through such elements as the quadrangle form, castellated parapets, cloisters, bayed windows, and pinnacled and gabled parapet ends.

The Law School Building and Old Quadrangle is architecturally significant one of the finest and oldest non-ecclesiastical Gothic revival structures in Victoria and the most important of architect F M White's works. The stone carvings in the cloisters and around the windows and doors are highly distinctive features. The cloister vaulting and corridor arches are unusual.

The Law School Building and Old Quadrangle is socially significant for the inclusion of professional accommodation to foster social as well as intellectual interaction with the students. The main buildings are also important for their association with the University's Faculty of Law, the first faculty at the University and Victoria's leading legal training school. The Quadrangle still forms the core of the present campus.

## Permit Exemptions

### General Exemptions:

General exemptions apply to all places and objects included in the Victorian Heritage Register (VHR). General exemptions have been designed to allow everyday activities, maintenance and changes to your property, which don't harm its cultural heritage significance, to proceed without the need to obtain approvals under the Heritage Act 2017.

Places of worship: In some circumstances, you can alter a place of worship to accommodate religious practices without a permit, but you must **notify** the Executive Director of Heritage Victoria before you start the works or activities at least 20 business days before the works or activities are to commence.

Subdivision/consolidation: Permit exemptions exist for some subdivisions and consolidations. If the subdivision or consolidation is in accordance with a planning permit granted under Part 4 of the *Planning and Environment Act 1987* and the application for the planning permit was referred to the Executive Director of Heritage Victoria as a determining referral authority, a permit is not required.

Specific exemptions may also apply to your registered place or object. If applicable, these are listed below. Specific exemptions are tailored to the conservation and management needs of an individual registered place or object and set out works and activities that are exempt from the requirements of a permit. Specific exemptions prevail if they conflict with general exemptions.

Find out more about heritage permit exemptions [here](#).

Construction dates	1854,
Architect/Designer	White, FM,
Heritage Act Categories	Registered place,
Hermes Number	912
Property Number	

---

## History

History of Place:

(from Joy McCann, The University of Melbourne Historical Assessment of Buildings, 1992.)

The foundation stone was laid for the first University building on 3 July 1854, following royal assent of the University Act in 1853. The design for the two-storeyed building had been accepted from FM White following a design competition. The government grant was cut at a crucial time and only the east and west wings of White's plan were completed. The two wings accommodated the first four professors appointed to the University, together with private lecture rooms.

Redmond Barry, first Chancellor of the university, wanted the buildings to be in an appropriate collegiate style, a clear reference to the Gothic of Oxford and Cambridge.

The north wing of the Quadrangle was completed in 1857, housing two more lecture theatres and a physics laboratory. On the second floor collections from the National Museum were held.

From 1857 legal studies were introduced, establishing the long tradition of the Quadrangle with the Law Faculty, which was formally created in 1873. The University Council were concerned to separate Law from Arts, whereas the two had previously been closely associated. The Quadrangle complex remained uncompleted for a long time, until 1930.

Associated People: Reed & Barnes

Gawler & Drummond

Rae Featherstone

## Extent of Registration

### AMENDMENT OF REGISTER OF HISTORIC BUILDINGS

Historic Building No. 920.

### OLD QUADRANGLE AND LAW SCHOOL BUILDINGS, THE UNIVERSITY OF MELBOURNE

(To the extent of:

1. the whole of the building known as the Old Quadrangle and Law School, University of Melbourne, Parkville, shown marked B-1 on Plan 6032911(A), endorsed by the Chairperson, Historic Buildings Council and held by the Director, Historic Buildings Council.

2. The land extending

**south** - the whole of the South Lawn (excluding the underground carpark)

**west** - the whole of the Cussonia Court

**north** - the whole of the South Court of the union from the north face of the Old Quadrangle including the present site of the bookroom (but excluding the bookroom building)

**east** - the land between Quadrangle and Law Library, whole of MacFarland Court-

this being part of the land described in Certificate of Title Volume 8876 Folio 379 and marked L-1 on Plan 6032911(b), endorsed by the Chairperson, Historic Buildings Council and held by the Director, Historic Buildings Council.)

[Victoria Government Gazette No. G24 24 June 1992 p.1578]

*This place/object may be included in the Victorian Heritage Register pursuant to the Heritage Act 2017. Check the Victorian Heritage Database, selecting 'Heritage Victoria' as the place source.*

*For further details about Heritage Overlay places, contact the relevant local council or go to Planning Schemes Online <http://planningschemes.dpcd.vic.gov.au/>*