

FORMER WESLEYAN CHURCH



FORMER WESLEYAN
CHURCH SOHE 2008



FORMER WESLEYAN
CHURCH SOHE 2008



FORMER WESLEYAN
CHURCH SOHE 2008



FORMER WESLEYAN
CHURCH SOHE 2008



FORMER WESLEYAN
CHURCH SOHE 2008



former wesleyan church
portland front view of church
jun1981



1 former wesleyan church
portland manse front view

EXTENT OF DESIGNATION (SUMMARY)

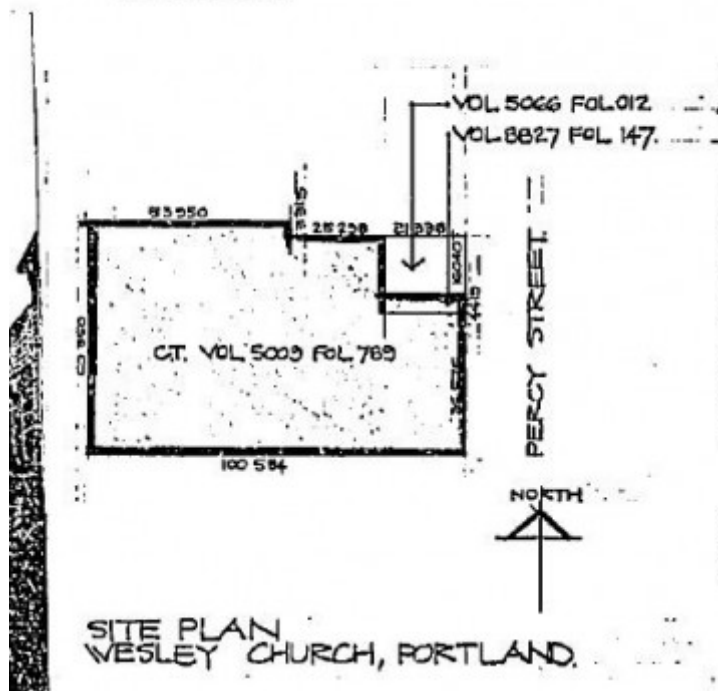

H0643 H0643 plan

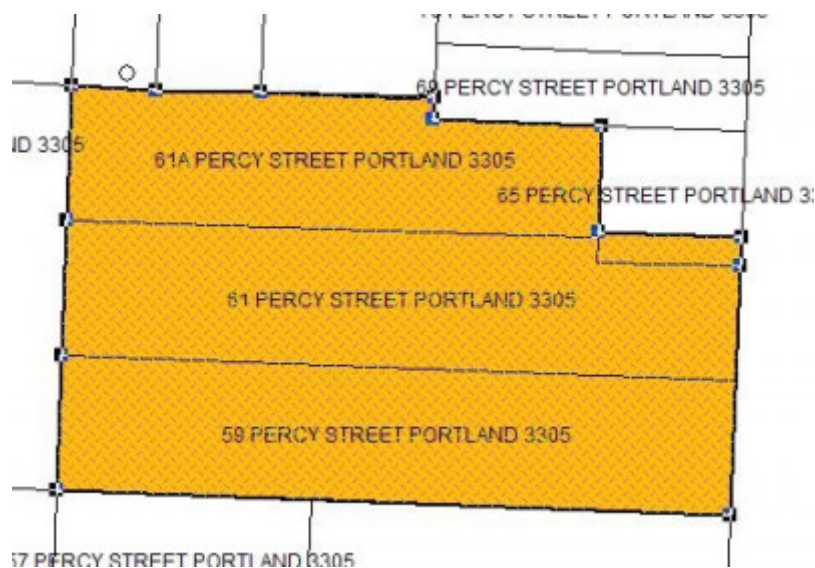

H0643 location

Location

59-61A PERCY STREET PORTLAND, GLENELG SHIRE

Municipality

GLENELG SHIRE

Level of significance

Registered

Victorian Heritage Register (VHR) Number

H0643

Heritage Overlay Numbers

HO58

VHR Registration

March 11, 1987

Heritage Listing

Victorian Heritage Register

Statement of Significance

Last updated on - June 24, 1999

Construction of the Uniting Church in Percy Street, Portland, the third Wesleyan church to be built in the town, began in 1865. The building was designed by local architect Daniel Nicholson with a sophisticated classical temple street elevation in a style derived from English Renaissance architecture, notably the work of Christopher Wren and Nicholas Hawksburn. The fine craftsmanship of the bluestone moor exterior is outstanding and is the work of stonemasons, C Webber & Sons. The church was extended with a bluestone Sunday school room at the rear in 1868. A further bluestone extension of three classrooms was built in 1883. A later timber room has been added on the south side of the Sunday school.

The bluestone manse was constructed in 1868. This simple three roomed house was altered in 1899 when timber additions were made to the rear. The front verandah also probably dates from this phase of extensions. Following the completion of the church in 1867 an earlier church on the site was demolished and stones from it were used in the construction of the manse and the Sunday school addition.

Architecturally the church is one of the most important examples of the work of Daniel Nicholson and is one of the best examples of this style of church in the state. The integrity of the church is greatly enhanced by its landscaped forecourt and the adjoining manse.

The church has important historical associations with the eminent mission worker Rev. Francis Tucker-Field who was instrumental in bringing about the commencement of the project but died during its construction.

The Cork Oak (*Quercus suber*) is of significance.

Permit Exemptions

General Exemptions:

General exemptions apply to all places and objects included in the Victorian Heritage Register (VHR). General exemptions have been designed to allow everyday activities, maintenance and changes to your property, which don't harm its cultural heritage significance, to proceed without the need to obtain approvals under the Heritage Act 2017.

Places of worship: In some circumstances, you can alter a place of worship to accommodate religious practices without a permit, but you must [notify](#) the Executive Director of Heritage Victoria before you start the works or activities at least 20 business days before the works or activities are to commence.

Subdivision/consolidation: Permit exemptions exist for some subdivisions and consolidations. If the subdivision or consolidation is in accordance with a planning permit granted under Part 4 of the *Planning and Environment Act 1987* and the application for the planning permit was referred to the Executive Director of Heritage Victoria as a determining referral authority, a permit is not required.

Specific exemptions may also apply to your registered place or object. If applicable, these are listed below. Specific exemptions are tailored to the conservation and management needs of an individual registered place or object and set out works and activities that are exempt from the requirements of a permit. Specific exemptions prevail if they conflict with general exemptions.

Find out more about heritage permit exemptions [here](#).

Construction dates	1865,
Architect/Designer	Nicholson, Daniel,
Heritage Act Categories	Registered place,
Hermes Number	952
Property Number	

Extent of Registration

AMENDMENT OF REGISTER OF HISTORIC BUILDINGS

Historic Building No. 643, Uniting Church (Former Wesleyan Church), 61 Percy Street, Portland (to the extent of the whole of the Church, Sunday School addition, Manse and the whole of the land entered in the Register Book in Vol. 5009 Folio 789 and Vol. 8827 Folio 147 but excluding the limestone hall and the garage. A permit exemption applies to works to the interior of the Manse).

[*Victoria Government Gazette* No. G10 11 March 1987 p. 559]

This place/object may be included in the Victorian Heritage Register pursuant to the Heritage Act 2017. Check the Victorian Heritage Database, selecting 'Heritage Victoria' as the place source.

For further details about Heritage Overlay places, contact the relevant local council or go to Planning Schemes Online <http://planningschemes.dpcd.vic.gov.au/>