

URBRAE



URBRAE SOHE 2008



URBRAE SOHE 2008



1 urbrae hoddle street
richmond front view

EXTENT OF DESIGNATION (SUMMARY)

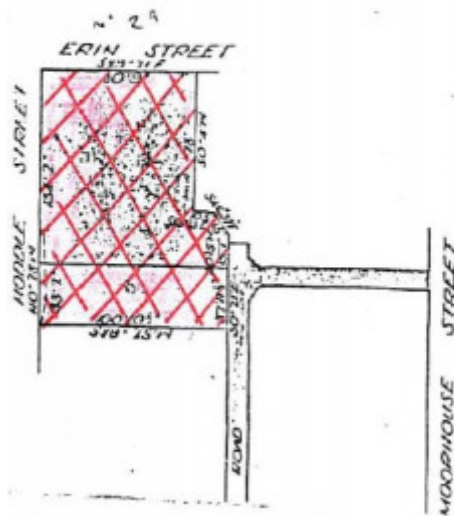

H0719 H0719 plan

Location

171 HODDLE STREET RICHMOND, YARRA CITY

Municipality

YARRA CITY

Level of significance

Registered

Victorian Heritage Register (VHR) Number

H0719

Heritage Overlay Numbers

HO276

VHR Registration

December 21, 1988

Heritage Listing

Victorian Heritage Register

Statement of Significance

Last updated on - July 16, 1999

What is significant?

Urbrae is situated on land that was subdivided from William Highett's 1839 crown grant. Three allotments were purchased by James P. Lind, a photographer, who combined them to form the present site and erected a two storey single fronted house. The medical men Thomas, James and William Boyd purchased the property in 1898. By 1901 the existing pair of semi-detached houses had been established. The original house was converted into a double fronted two storey arcaded residence and attached to a two storey house with return verandahs and an impressive tower over the entrance. The arcaded Italian renaissance-derived style of the front elevation is believed to be the work of the architect JAB. Koch who worked extensively in Richmond. The integrity of the pair of houses is excellent. An early decorative scheme remains in the entrance hall of the house on the left.

How is it significant?

Urbrae is of historical and architectural significance to the State of Victoria.

Why is it significant?

Urbrae is of historical significance as the residence of the Boyd family of noted medical practitioners. Dr Thomas Boyd was the government vaccinator while Dr William Boyd was an eminent pathologist. William lived here until his death in 1935. The substantial house provides some indication of the success of the family and of the social prominence of medical professionals in late 19th century Melbourne.

Urbrae is of historical significance as evidence of the process of suburban change during the 19th century. Richmond Hill, the location of Urbrae, became, like many elevated areas within Melbourne's suburbs, the location for the houses of the wealthy, as the rest of Richmond became increasingly industrialised and inhabited by the working class. In the case of Urbrae, Lind's original, modest house was converted to a more substantial residence, more befitting the location and respectability of its residents.

Urbrae is of architectural significance as an impressively sited (on the brow of Richmond Hill) late Victorian pair of semi-detached houses and for the quality of its Italian renaissance- style front elevation.

Permit Exemptions

General Exemptions:

General exemptions apply to all places and objects included in the Victorian Heritage Register (VHR). General exemptions have been designed to allow everyday activities, maintenance and changes to your property, which don't harm its cultural heritage significance, to proceed without the need to obtain approvals under the Heritage Act 2017.

Places of worship: In some circumstances, you can alter a place of worship to accommodate religious practices without a permit, but you must **notify** the Executive Director of Heritage Victoria before you start the works or activities at least 20 business days before the works or activities are to commence.

Subdivision/consolidation: Permit exemptions exist for some subdivisions and consolidations. If the subdivision or consolidation is in accordance with a planning permit granted under Part 4 of the *Planning and Environment Act 1987* and the application for the planning permit was referred to the Executive Director of Heritage Victoria as a determining referral authority, a permit is not required.

Specific exemptions may also apply to your registered place or object. If applicable, these are listed below. Specific exemptions are tailored to the conservation and management needs of an individual registered place or object and set out works and activities that are exempt from the requirements of a permit. Specific exemptions prevail if they conflict with general exemptions.

Find out more about heritage permit exemptions [here](#).

Construction dates	1839,
Architect/Designer	Koch, JAB,
Heritage Act Categories	Registered place,
Hermes Number	980
Property Number	

Extent of Registration

AMENDMENT OF REGISTER OF HISTORIC BUILDINGS

Historic Building No. 719.

Urbrae - 171 Hoddle Street, Richmond

to the extent of the whole building known as Urbrae and the land shown hatched, but excluding the two storey block of flats to the north of Urbrae, which are included in the Register Book Certificate of Title Volume 6557 Folio 1311318.

[*Victoria Government Gazette* G49 21 December 1988 p.3902]

This place/object may be included in the Victorian Heritage Register pursuant to the Heritage Act 2017. Check the Victorian Heritage Database, selecting 'Heritage Victoria' as the place source.

For further details about Heritage Overlay places, contact the relevant local council or go to Planning Schemes Online <http://planningschemes.dpcd.vic.gov.au/>